

*Limestone  
County Commission*

*Chairman  
Collin Daly*

*Administrator  
Ellen Morell*



*Commissioners:  
Daryl Sammet  
Danny Barksdale  
Derrick Gatlin  
LaDon Townsend*

**October 6, 2023**

**INVITATION FOR BIDS  
PROPOSAL NO. 2845**

**BUILDING IMPROVEMENTS TO EXISTING  
60X40 SHOP BUILDING**

Notice is hereby given that the Commission of Limestone County, Alabama will receive competitive sealed bids on the following items:

**BUILDING IMPROVEMENTS TO EXISTING 60X40 SHOP BUILDING. SEE ATTACHED SPECIFICATIONS.**

**BIDS:** All applicable taxes, fees and additional costs must be included in the amount of bid price.

Date of Delivery: **ON OR BEFORE 60 DAYS FROM NOTICE TO PROCEED.** Terms: **ON RECEIPT**

You are invited to bid on the attached specifications. Any substitutes offered must be submitted in detail. The right to reject any items not of quality or under any provisions of this act is reserved.

Bids will be opened on **Tuesday, the 31<sup>st</sup> day of October 2023, at 10:00 a.m.** and awarded on **Monday, the 6<sup>th</sup> day of November 2023, at 10:00 a.m.**

**REQUIREMENT:** Pursuant to Alabama Code § 31-13-9, as a condition of the award of any contract, the business entity or employer, and any of its subcontractors, shall provide a sworn affidavit and documentation that it will not knowingly employ, hire for employment, or continue to employ an unauthorized alien; that it is enrolled in the E-Verify program; and, during the contract period, it will participate in the E-Verify program and will verify every employee that is required to be verified under applicable state and federal laws. During the performance of the contract, the business entity or employer shall participate in the E-Verify program and shall verify every employee that is required to be verified according to the applicable federal rules and regulations.

**All bids must be sealed, and the word "BID," name of item, proposal number, and opening date must be marked on the outside of the envelope. Bids must be mailed or hand delivered. No emailed bids will be accepted.**

**Submit bids to: Limestone County Commission  
310 W. Washington Street  
Athens, AL 35611**

A handwritten signature in black ink, appearing to read 'Collin Daly', is written over a horizontal line.

**COLLIN DALY, Chairman  
Limestone County Commission**

## SPECIFICATIONS FOR BUILDING IMPROVEMENTS AND PLUMBING/ELECTRICAL INSTALLATIONS

Any bid is to be constructed within 90 days of the approval of this bid and must meet or exceed the following specifications and installation per the attached proposed layout. Any exceptions to the bid specification or timeframe must be noted on this bid.

Please see attached drawings for supplemental information.

**Utility Connections:** Contractor will be responsible for making all utility connections to existing services, water service should be ½" PEX or similar, sewer should be 6" PVC or similar. All existing utilities are approximately 50' to the south, adjacent to an office trailer. Contractor will be responsible for installing breaker box in the NW corner of building. All wiring must be in conduit. Any exterior plumbing should be installed below frostline or encapsulated and insulated.

**Office/Bathroom Construction:** Wall construction should be gypsum and insulated on outer walls, ceiling should be reinforced for overhead storage with a staircase constructed on the north wall for access. Office should have a 36" door with lock and an approximate 24" wide window as shown on drawing. Bathroom should have 36" door, both doors should have automatic closers. Floor should be "raised" so utilities can be installed without cutting existing concrete slab. Two toilets with stalls, one urinal and one sink installed in bathroom. Sink should have electric tankless wall mount hot water heater. A "ductless" HVAC system should be installed so that there is a separate air-handler for each room and a shared compressor. Flooring should be commercial quality vinyl plank or similar.

**Lean-To Construction:** Structure should be built with wood and roofing material should match existing building. Wall plate for roof should be a minimum of 3" below existing roof line and drip edge should be installed to ensure water flows off existing roof onto lean-to roof and into gutters. Guttering should be installed to direct water to downspout on the west side of the lean-to.

**Guttering:** Guttering should be installed to direct water to downspout on the north side of the existing building.

**Ventilation Fan:** A 48" shroud style ventilation fan should be installed on the west wall made to pull air out of the building. Fan can be installed on either the left or right of center post and above the metal clad wall panels.

**Interior Lighting:** On drawing where "LED" is shown, fixture must be 4' (2) bulb T8 style LED. Individual rooms must have their own switches. Lights in the main shop area should have a switch for all fixtures on the left side and right side independently, three-way light switches for interior lights should be placed at both walk-thru doors.

**Exterior Lighting:** On drawing where "Ext. LED" is shown, fixture must be suitable for outdoor use and utilize an LED bulb. Lights should be connected to a "dusk to dawn" photocell for off/on.

**LED Lights Under Lean-To:** LED lights under lean-to on drawing should be suitable for outdoor use and wired to a switch for left and right side independently. Switched should be placed inside building at the walk-thru doors on each side.

**Interior Electrical Receptacles:** On drawing where "E" is shown, receptacle should be a duplex 125V AC grounded in an approved box with cover. On drawing where "250E" is shown, receptacle should be a 250V AC grounded in an approved box with cover.

**Exterior Electrical Receptacles:** On drawing where "E" is shown, receptacle should be a duplex 125V AC grounded in an approved box with cover, suitable for outdoor use.

**Shop Sink:** Install a 36" wide "shop" or similar sink located adjacent to the bathroom as shown on drawing, with a GFI electrical receptacle.

**Overhead Airline:** Compressor will be located outside on the NW corner of the building. Limestone County will provide the compressor. Contractor will be responsible for installing electrical, air connection, and water separator for compressor. Line should extend overhead as shown on drawing with one  $\frac{1}{2}$ " drop and two  $\frac{3}{8}$ " drops as shown.

This bid will be awarded to the vendor based on the lowest cost using the Total Cost above.

COMPANY NAME:

---

ADDRESS:

---

---

CONTACT PERSON:

---

Please Print

SIGNATURE:

---

E-MAIL:

---

PHONE:

---

***By signing this contract, the contracting parties affirm, for the duration of the agreement, that they will not violate federal immigration law or knowingly employ, hire for employment, or continue to employ an unauthorized alien within the State of Alabama. Furthermore, a contracting party found to be in violation of this provision shall be deemed in breach of the agreement and shall be responsible for all damages resulting therefrom.***

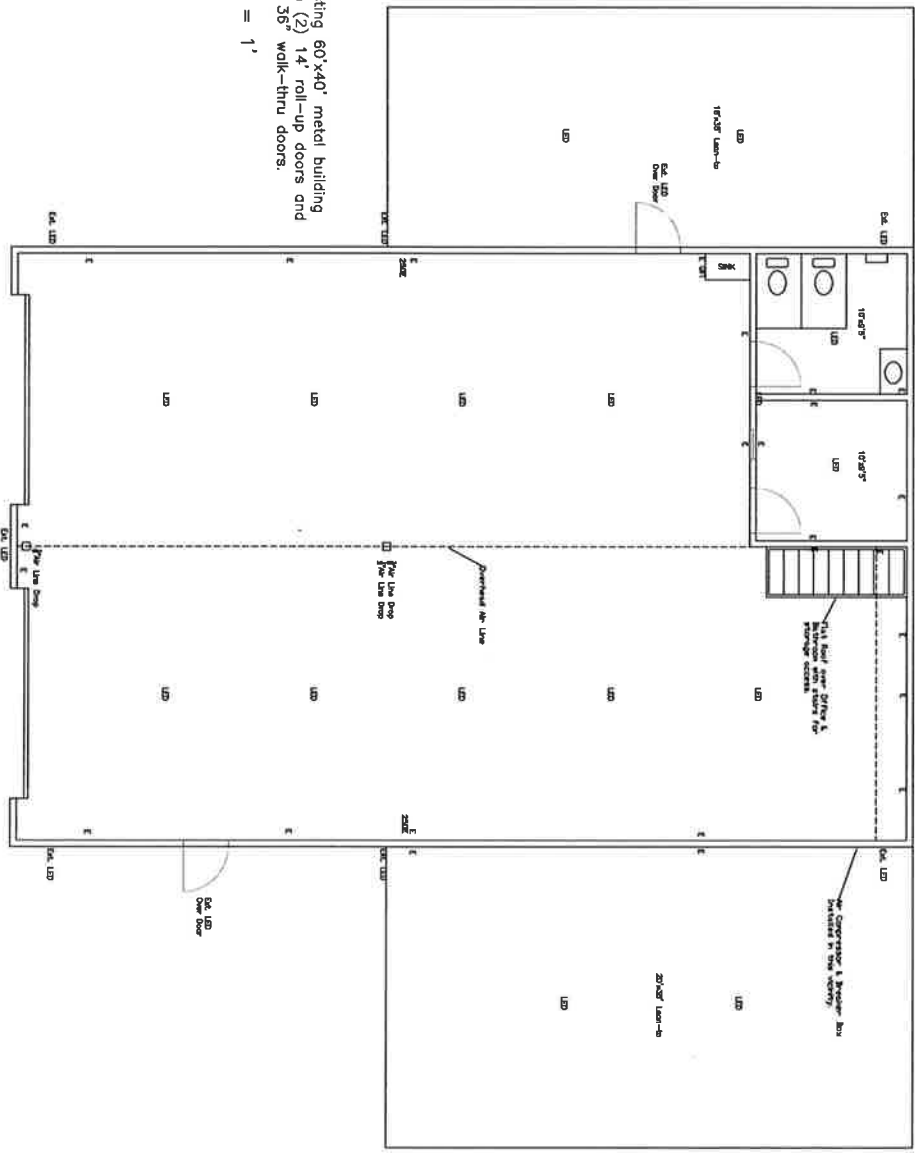

Existing 60'x40' metal building  
 with (2) 14' roll-up doors and  
 (2) 36\" walk-thru doors.

$$\frac{1}{8}'' = 1'$$